

## Part. S0708

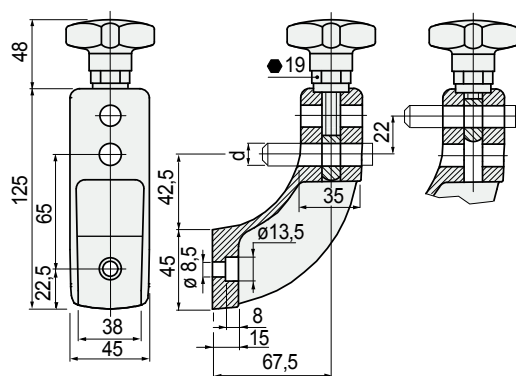

### Bracket with two holes

#### Version without positioning guide



Pin dia.  
d  
mm

**Code**

Weight  
kg

#### Version without positioning guide

12

**692502**

0,23

- Material: bracket and knob in reinforced polyamide PA FV (black).
- Hexagonal insert (for 19 mm wrench) in nickel plated brass.
- Eyebolt in austenitic stainless steel.
- Max recommended tightening torque: 4 Kgm.
- Packaging: 12 pieces.

#### • Characteristics of Part. S0708

- Bracket with a reduced structure-connecting size.
- Available with positioning guide for an easy assembly on aluminium sections.
- The two holes allows to position the guide-rail bracket in two different heights depending on specific requirements.

#### • Assembly version with positioning guide

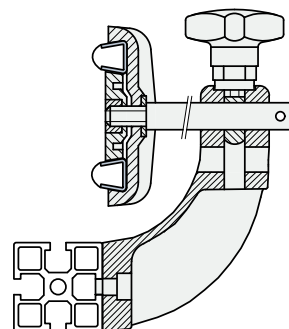

#### • Assembly version without positioning guide

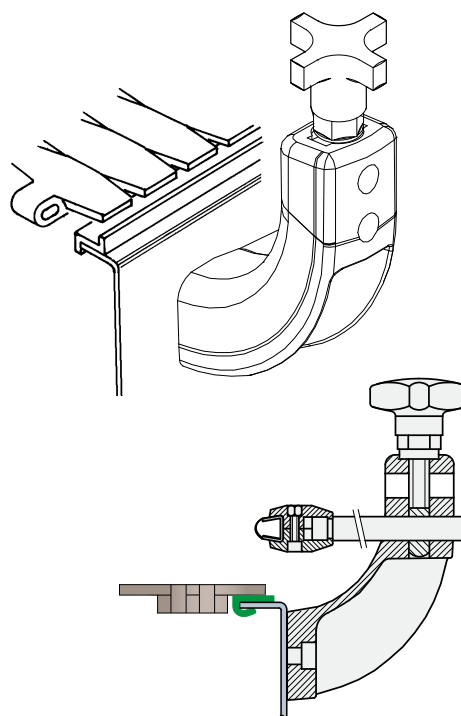

#### • Assembly version with centering pin