

## Positioning

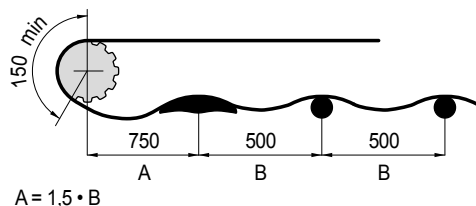

## Assembly

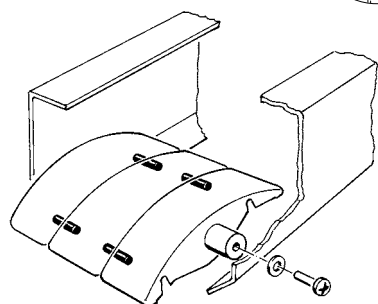
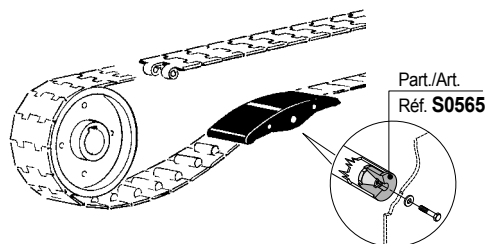

Shoes can be pinned together

## TableTop® chains / PlateTop chains

Chain width 82,5 mm (K 325)

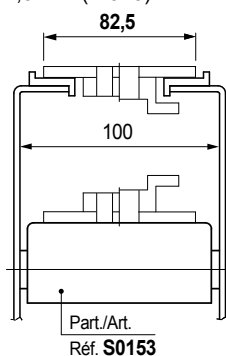

Chain width 82,5mm (K 325) / Pitch 88mm

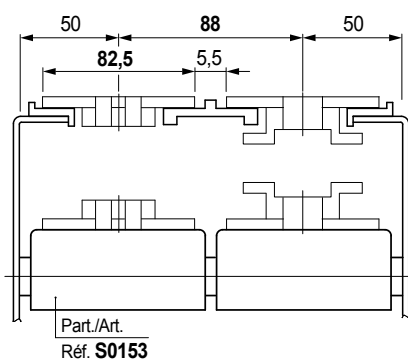

## Wear shoe

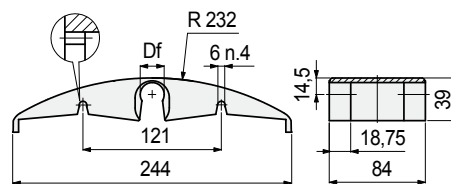

Shaft dia. mm	Bore dia. Df mm	Materiale	Code
18	18,5	Polyethylene PE (green)	<b>608692N1</b>
20	20,5	Polyethylene PE (green)	<b>684231N1</b>

- New UNL™ low noise material is recommended only with LBP chains.
- PE polyethylene (green) version is recommended with plastic chains and metal chains.
- PA polyamide (black) version is recommended only with metal chains.
- The use of only one wear shoe after the catenary is recommended, with the exception of LBP chains that can run on more wear shoes.
- Packaging: 15 pieces.

## Part. S0153



Snap-on assembly

Chain width 82,5mm (K 325) / Pitch 85mm

