

## • Assembly Part. S0341 C

Types of reflectors that can be mounted:

Reflector with clip-on fixing pin: press-fit between clip and clamp hole.

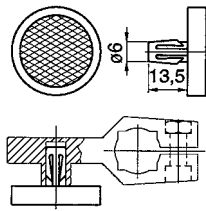

## • Operating principle

The beam of light emitted by source E is reflected by reflector C and conveyed to receiver R. Reading is performed through interruption of the beam of light.

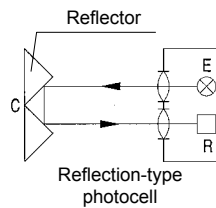

## • Assembly of photocells or sensors

The clamp can also be drilled to hold dia. 8-10-12-14 mm photocells or sensors.

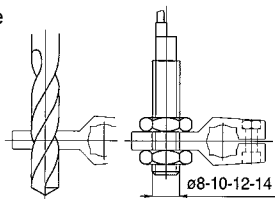

## • Suitable reflector type

Imos

## ■ Clamp for reflectors

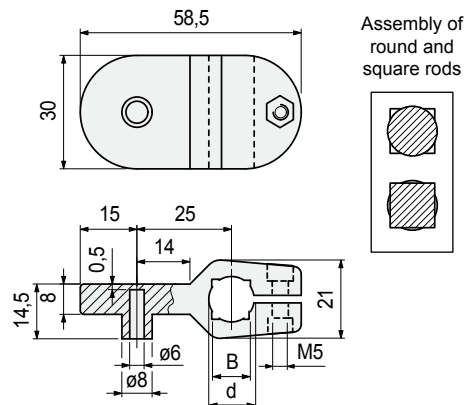

| Tightening bolt material   | Rod dia. d mm | Square rod B mm | Code    | Weight kg |
|----------------------------|---------------|-----------------|---------|-----------|
| Austenitic stainless steel | 10            | 8               | 6721500 | 0,02      |
|                            | 12            | 10              | 6912500 |           |
|                            | 14            | 12              | 6913500 |           |
| Zinc plated steel          | 10            | 8               | 6270910 | 0,02      |
|                            | 12            | 10              | 6271010 |           |
|                            | 14            | 12              | 6271110 |           |

- Material: clamp in reinforced polyamide PA FV (black).
- Max recommended tightening torque: 0,5 Kgm.
- Packaging: 50 pieces.

## Part. S0341C



● Best Seller

● Standard

● On request: minimum quantity may apply. Consult our Customer Service for availability.

Item code for order = Part. + Code