

## • Characteristics of Part. S0708

- Bracket with a reduced structure-connecting size.
- Available with positioning guide for an easy assembly on aluminium sections.
- The two holes allows to position the guide-rail bracket in two different heights depending on specific requirements.

## • Assembly version with positioning guide

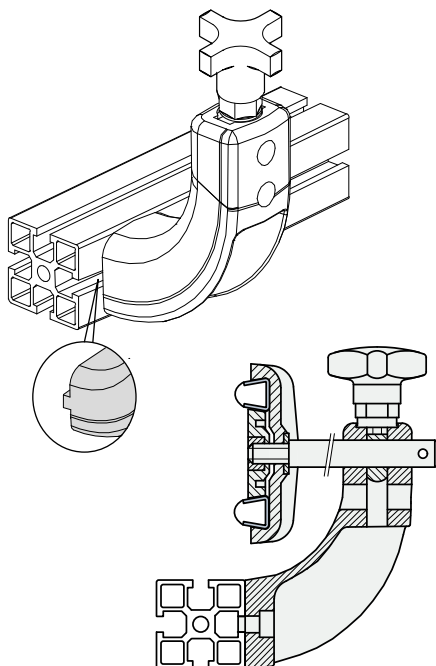

## • Assembly version without positioning guide

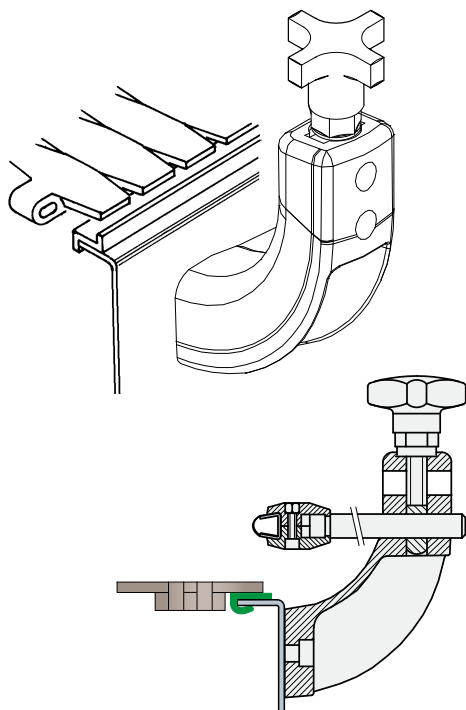

## • Assembly version with centering pin

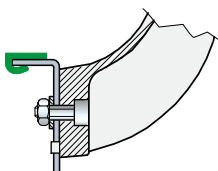

## ■ Bracket with two holes

### Version without positioning guide

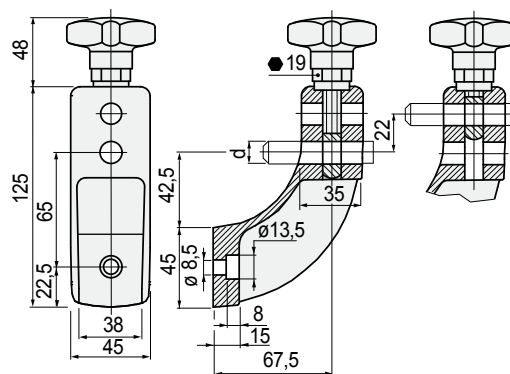

### Version with positioning guide

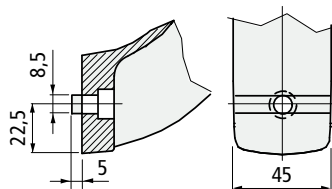

### Version with centering pin

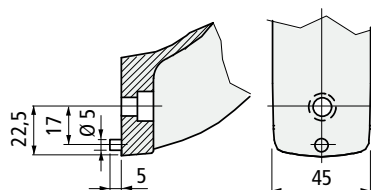

## Part. S0708



Pin dia. d mm	Code	Weight kg
Version without positioning guide		
12	692502	0,23
14	693092	
16	692512	
Version with positioning guide		
12	692482	0,23
14	693082	
16	692492	
Version with centering pin		
12	605603	0,23
14	605613	
16	605623	

- Material: bracket and knob in reinforced polyamide PA FV (black).
- Hexagonal insert (for 19 mm wrench) in nickel plated brass.
- Eyebolt in austenitic stainless steel.
- Max recommended tightening torque: 4 Kgm.
- Packaging: 50 pieces.

● Best Seller

● Standard

● On request: minimum quantity may apply. Consult our Customer Service for availability.

Item code for order = Part. + Code