

- **Material:** Polyethylene UHMWPE with molecular density 5.600.000 g/mol.

Characteristics: new material Polyethylene ULF™ brown red (UHMWPE): reduced friction coefficient, higher wear resistance.

- **Operating temperature White:**

In air (- 40 to + 80 °C).

In hot water (+ 70 °C).

- **Operating temperature ULF™ brown red:**

In air (- 40 to + 45 °C).

In hot water (+ 45 °C).

- **Polyethylene ULF™ is FDA approved**

Polyethylene ULF™ complies with the Code of Federal Regulations Title 21, § 177.1520 "Olefin Polymers" of the Food and Drug Administration (FDA) of April 1, 2008.

- **Coefficient of friction between chain POM and wearstrip ULF™:** 0,08.

Note: for calculation of chain pull refer to Technical Support.

- **Position of guides.** See Technical information.

- **Head joint**

Head joint shall be made with a 45° cut to avoid steps and guarantee chain smooth movement. With temperature increase it is necessary to leave a gap wide enough to allow for thermal elongation of plastic parts.

- **MatTop® modular chain**

Parallel wear strip.

Recommended with medium-light loads.

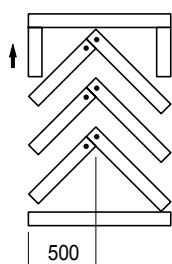
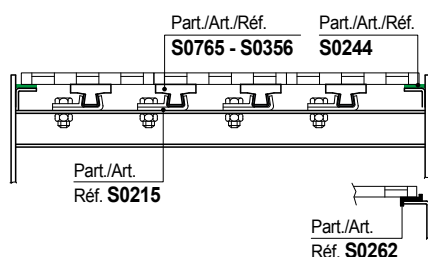

**CHEVRON pattern.**  
Recommended with high loads (accumulation tables)  
Chain wear is evenly distributed throughout the width.

## Chain - guide profile

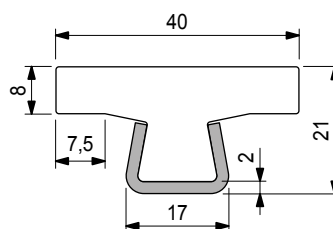

| Colour | Length metres | Code  | Weight kg/m |
|--------|---------------|-------|-------------|
| White  | 3             | 61605 | 0,89        |
|        | 6             | 61615 |             |

- Material: metal profile austenitic stainless steel.
- Linear expansion coefficient:  $4 \times 10^{-5} \text{ } ^\circ\text{C}^{-1}$ .
- Calculation of thermal expansion see Technical information.
- Packaging: 24 metres.

## Chain - guide profile

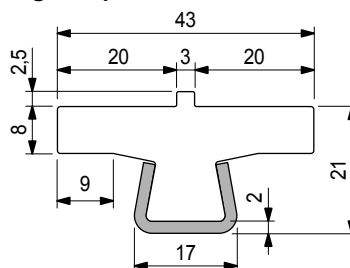

| Colour | Length metres | Code  | Weight kg/m |
|--------|---------------|-------|-------------|
| White  | 3             | 65612 | 0,95        |
|        | 6             | 69412 |             |

- Material: metal profile austenitic stainless steel.
- Linear expansion coefficient:  $4 \times 10^{-5} \text{ } ^\circ\text{C}^{-1}$ .
- Calculation of thermal expansion see Technical information.
- Packaging: 24 metres.

## Chain - guide profile

| S   | H    | A  |
|-----|------|----|
| mm  | mm   | mm |
| 1,5 | 20,5 | 16 |
| 2   | 21   | 17 |

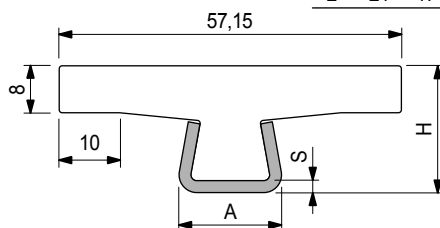

| Thickness S mm | Metal profile material     | Length metres | Code    | Weight kg/m |
|----------------|----------------------------|---------------|---------|-------------|
| 1,5            | Austenitic stainless steel | 3             | 608943N | 0,95        |
|                |                            | 6             | 608953N |             |
|                | Zinc plated steel          | 3             | 608963N |             |
| 2              | Austenitic stainless steel | 3             | 608973N | 1,06        |
|                |                            | 6             | 608983N |             |

- Colour: white.
- Min. curvature radius: 200 mm.
- Linear expansion coefficient:  $4 \times 10^{-5} \text{ } ^\circ\text{C}^{-1}$ .
- Calculation of thermal expansion see Technical information.
- Packaging: 24 metres.

## Part. S0356



## Part. S0310



## Part. S0765



● Best Seller

● Standard

● On request: minimum quantity may apply. Consult our Customer Service for availability.

Item code for order = Part. + Code